

## Port patterns NG 3 to NG 25

110410\_port\_patterns\_e  
07.2018

### Table of contents

Contents	Page
NG 3	1
NG 3 compact	2
NG 4 compact	2
NG 4	3
NG 6	3
NG 10	4
NG 16	4
NG 25	5

#### NOTE

- Screw-in depth of mounting screws:  
 steel: approximately 1,0 - 1,3 x d  
 cast: approximately 1,3 - 1,5 x d  
 aluminium: approximately 1,5 - 2,0 x d  
 (d = diameter of thread)
- surface roughness at sealing area: Rz = 6,3

### NG 3

(company standard)

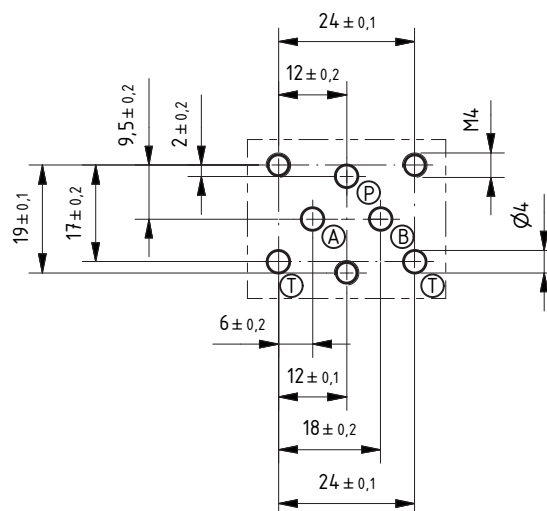

HE4/14 09 01

#### NOTE

Most sandwich- and top-mount bodies have a second T-port (bottom right), unlike most subplates, which usually just have one T-port.

### NG 3 compact

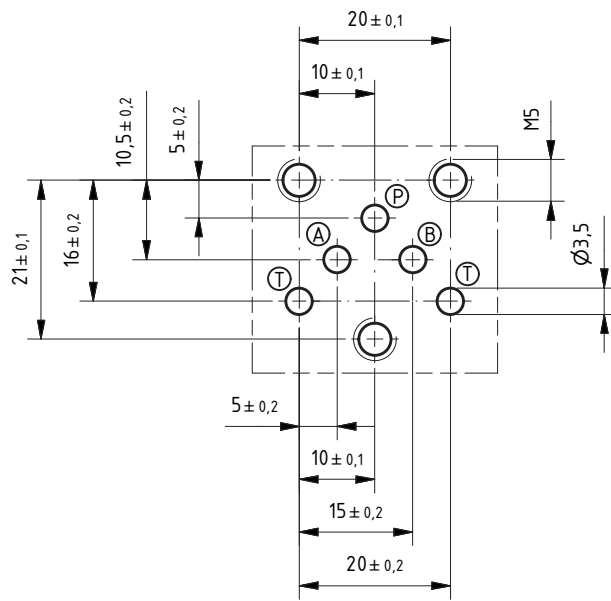

HE2/13 17 12

### NG 4 compact

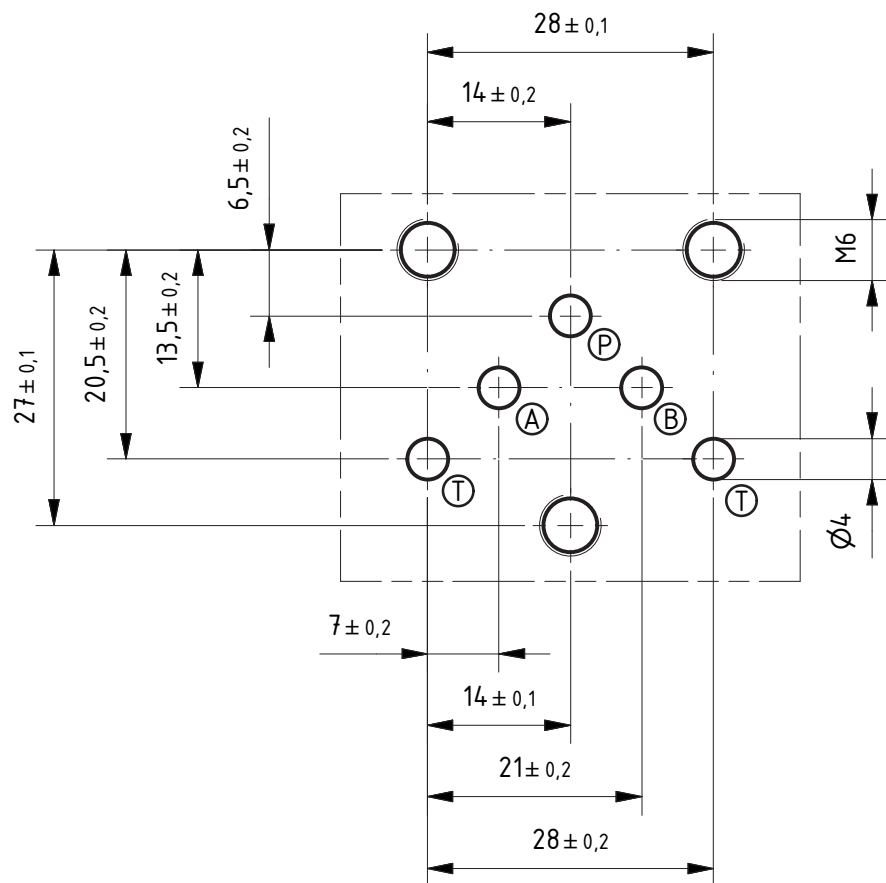

HE2/13 44 01

**NG 4**

ISO 4401-02-01\*

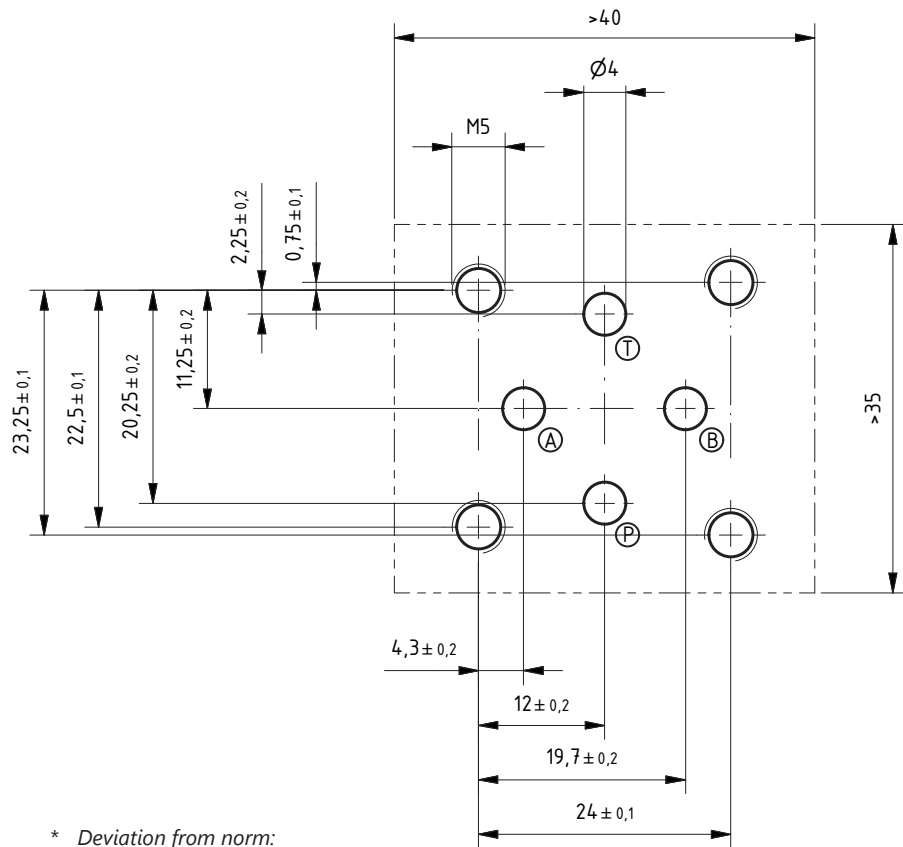

\* Deviation from norm:  
without drilling G

HE4/14 09 02

**NG 6**

DIN 24340 A06  
ISO 4401-03-02\*  
CETOP 3\*

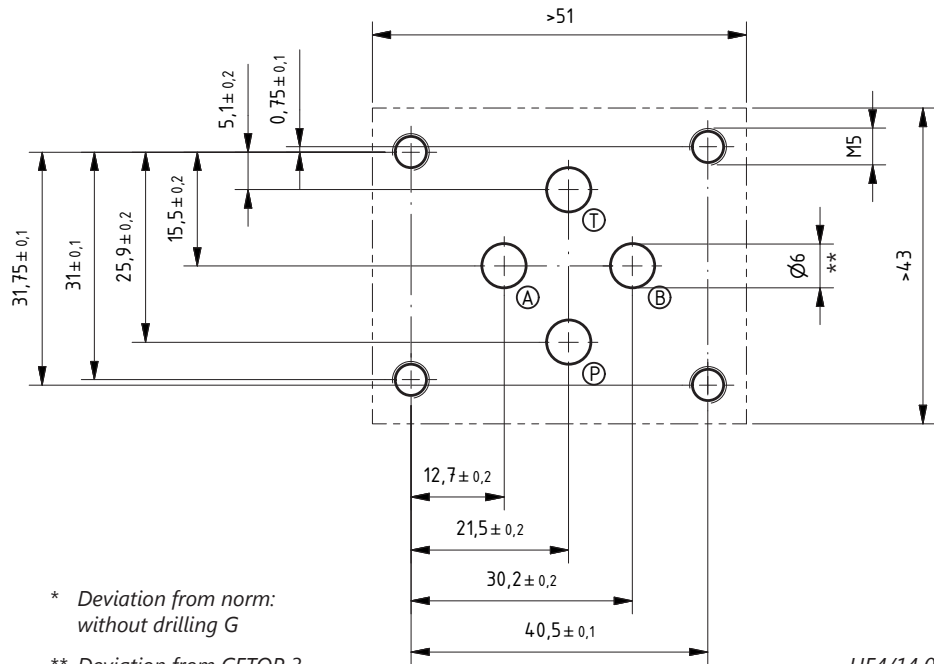

\* Deviation from norm:  
without drilling G

\*\* Deviation from CETOP 3

HE4/14 09 03

**NG 10**

DIN 24340 A10  
 ISO 4401-05-04  
 CETOP 5\*

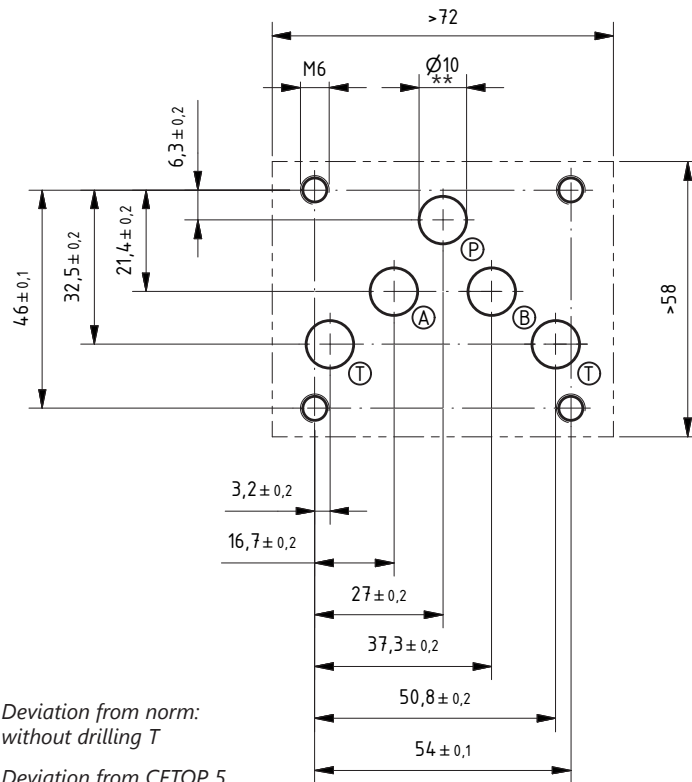

\* Deviation from norm:  
 without drilling T

\*\* Deviation from CETOP 5

HE4/14 09 04

**NOTE**

Most sandwich- and top-mount bodies have a second T-port (bottom right), unlike most subplates, which usually just have one T-port.

**NG 16**

DIN 24340 A16\*  
 ISO 4401-07-07\*  
 CETOP 7

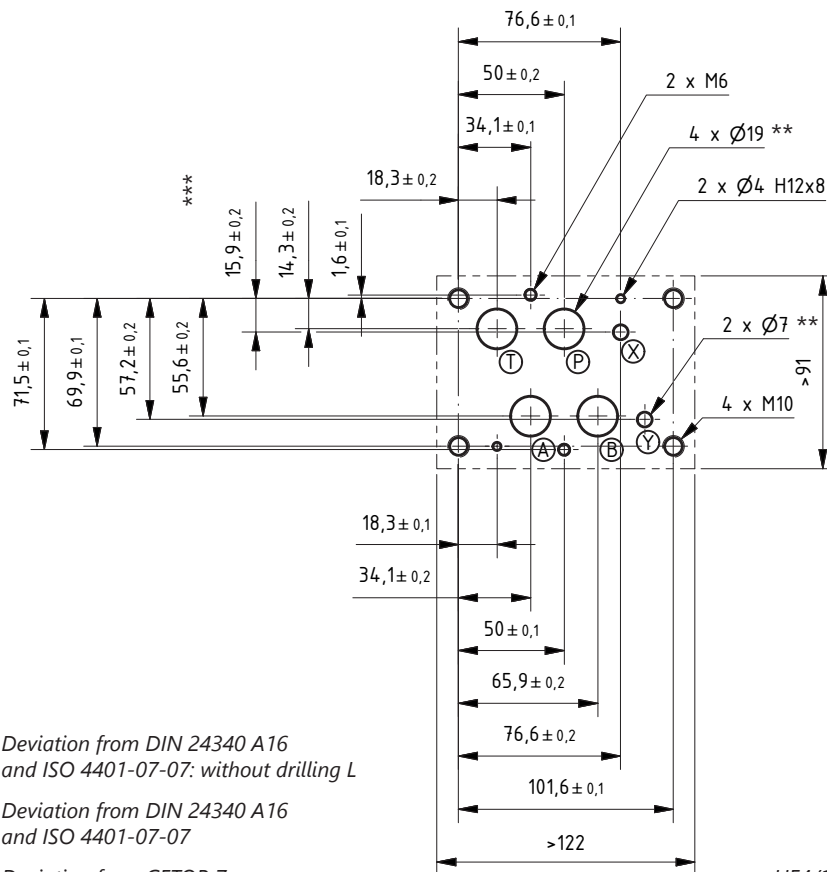

\* Deviation from DIN 24340 A16  
 and ISO 4401-07-07: without drilling L

\*\* Deviation from DIN 24340 A16  
 and ISO 4401-07-07

\*\*\* Deviation from CETOP 7

HE4/14 09 05

**NG 25**

DIN 24340 A25\*  
 ISO 4401-08-08\*  
 CETOP 8

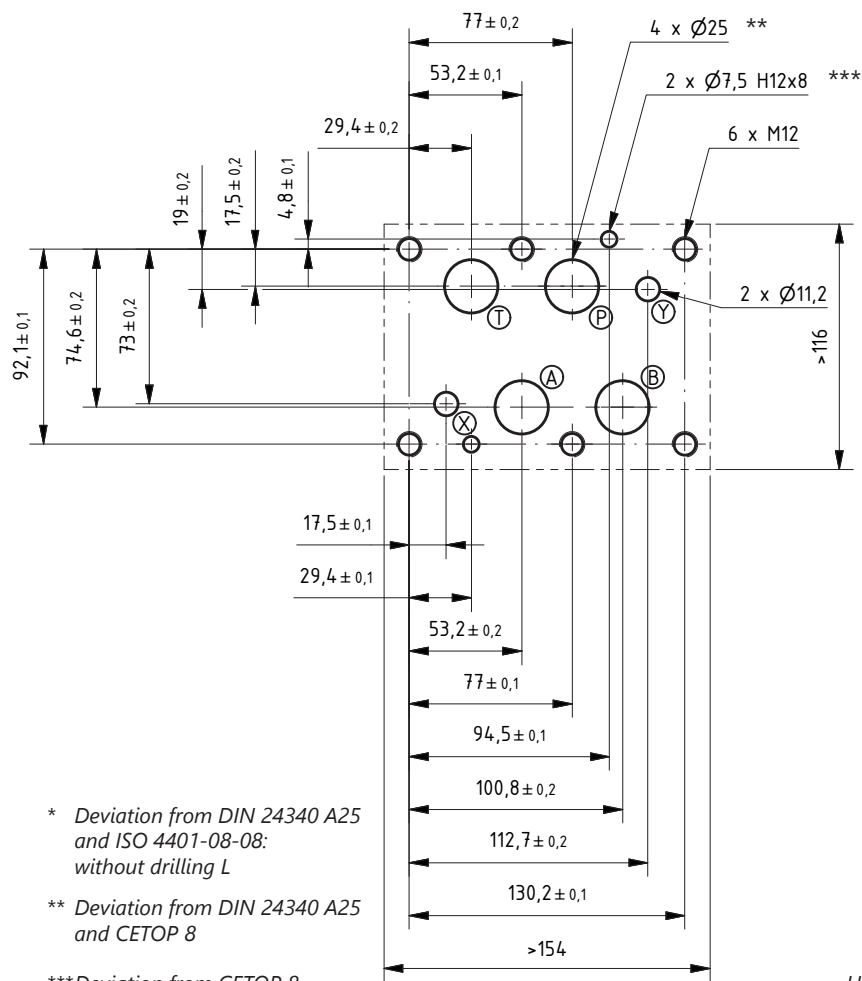

\* Deviation from DIN 24340 A25 and ISO 4401-08-08: without drilling L

\*\* Deviation from DIN 24340 A25 and CETOP 8

\*\*\* Deviation from CETOP 8

HE4/14 09 06



WEBER-HYDRAULIK ValveTech GmbH  
 Felix-Wankel-Str. 4, 78467 Konstanz  
 Phone: +49 7531 9748-0  
 Fax: +49 7531 9748-44

www.weber-hydraulik.com  
 info.de-k@weber-hydraulik.com

All rights reserved